

LEGEND - SIGNS & SYMBOLS

SIGN	CATALOG NO.	SIGN	CATALOG NO.
	80-9028 (B) ANK) VARIABLE LEGEND 60'X30"		80-9708 24'X18"
	80-9077 60'X30"		80-9080 48'X30"
	80-9916 48'X10' 80-9710 24'X30"		31-0557 48"
	80-9916 48'X10' 80-9710 24'X30"		
	80-9916 48'X10' 80-9710 24'X30"		
	80-9916 48'X10' 80-9710 24'X30"		

- NOTE**
1. ALL CONFLICTING SIGNS SHALL BE COVERED OR REMOVED.
 2. DETOUR SIGNS ARE ONLY TO BE POSTED WHEN DETOUR IS IN USE.
 3. DETOUR SIGNS SHOULD BE COVERED OR REMOVED WHEN DETOUR IS NOT IN USE.
 4. SIGN SUPPORTS SHALL BE TYPICAL METAL SIGN POSTS AS DETAILED ON CONN. DEPARTMENT OF TRANSPORTATION STANDARD SHEET NO. TR-1208 02.
 5. "ROAD CLOSED" AND "STOP" (31-0557) SIGNS SHALL BE DISPLAYED IN FRONT OF TYPE III BARRICADES.

- SIGN ON SINGLE POST
- SIGN ON DOUBLE POST
- PORTABLE SIGN SUPPORT
- BARRICADE WARNING LIGHT - HIGH INTENSITY
- TYPE III BARRICADE

DETAIL "A"

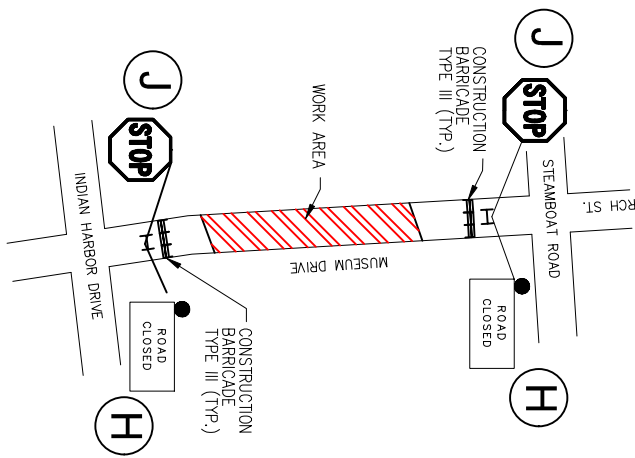

PRE DETOUR	CHANGEABLE MESSAGE SIGN

- NOTE:**
- DAILY CONSTRUCTION HOURS: 8 PM - 5 AM SUNDAY TO THURSDAY
 - MAINTAIN EXISTING PEDESTRIAN WALKWAYS.
- SEPTEMBER TO MAY - FULL ROAD CLOSURE PERMITTED FROM 8PM TO 5AM
- JUNE TO AUGUST - ONE WAY ALTERNATING TRAFFIC SHALL BE PERMITTED 8PM TO 9PM
- FULL ROAD CLOSURE 9PM TO 5AM

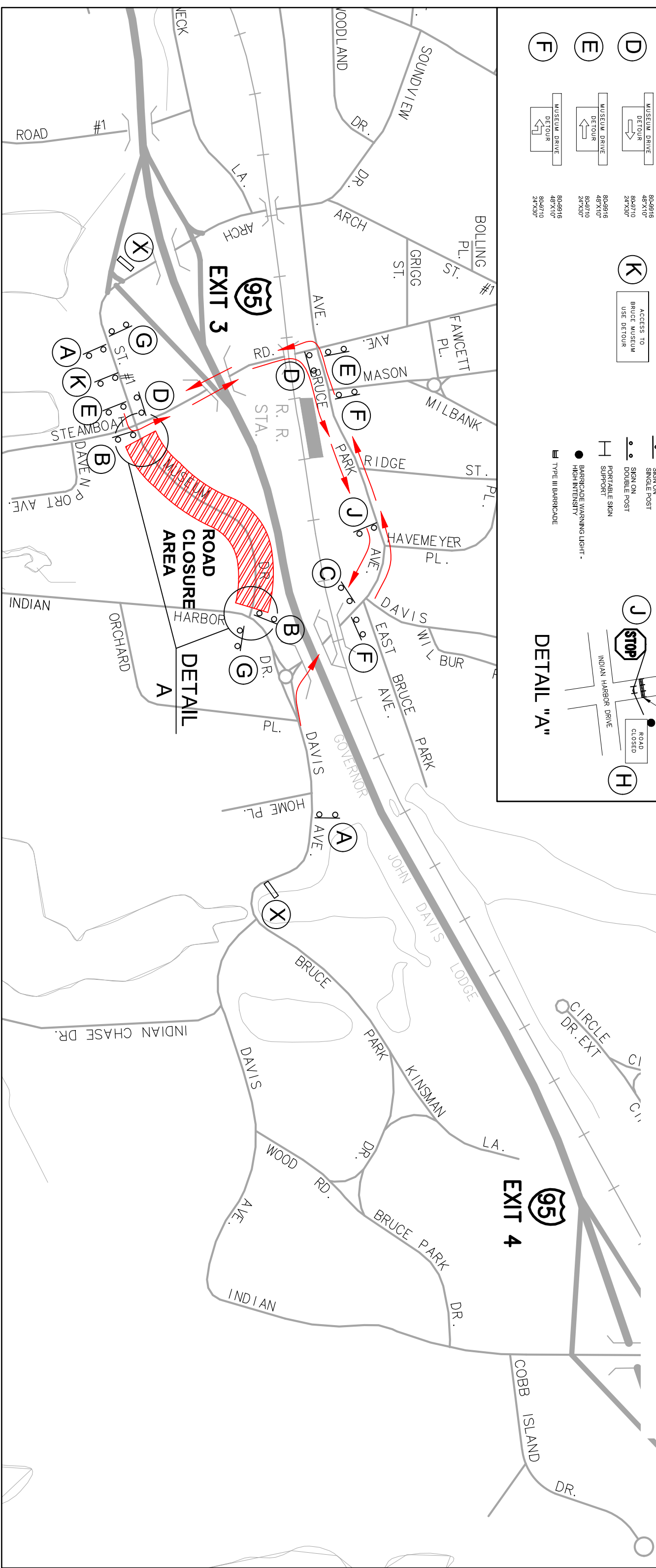

Alfred Benesch & Company • www.benesch.com
 120 Heiron Avenue • Glastonbury, Connecticut 06033
 Phone: (860) 633-8341 • Fax: (860) 633-1088

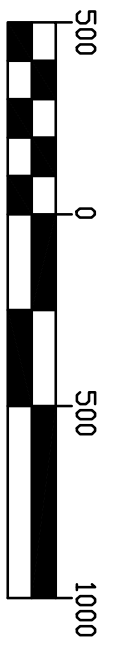

DETOUR PLAN 9A
MUSEUM DRIVE DETOUR
 EVERSOURCE 115 KV Underground Transmissions Facility
 From CosCob Substation To New Greenwich Substation