

LEGEND - SIGNS & SYMBOLS

SIGN	DOT CATALOG NO.	SIGN	DOT CATALOG NO.
A SOUND SHORE DRIVE CLOSED AHEAD NO THRU TRAFFIC	80-9928 (BLANK) VARIABLE LEGEND 60"x30"	F END DETOUR	80-9708 24"x18"
B ROAD CLOSED AHEAD LOCAL TRAFFIC ONLY	80-9077 60"x30"	G ROAD CLOSED	80-9080 48"x30"
C SOUND SHORE DRIVE DETOUR ↑	80-9916 48"x10" 80-9710 24"x30"	H STOP	31-0557 48"
D SOUND SHORE DRIVE DETOUR →	80-9916 48"x10" 80-9710 24"x30"		
E SOUND SHORE DRIVE DETOUR ←	80-9916 48"x10" 80-9710 24"x30"		

NOTE

1. ALL CONFLICTING SIGNS SHALL BE COVERED OR REMOVED.
2. DETOUR SIGNS ARE ONLY TO BE POSTED WHEN DETOUR IS IN USE.
3. DETOUR SIGNS SHOULD BE COVERED OR REMOVED WHEN DETOUR IS NOT IN USE.
4. SIGN SUPPORTS SHALL BE TYPICAL METAL SIGN POSTS AS DETAILED ON CONN. DEPARTMENT OF TRANSPORTATION STANDARD SHEET NO. TR-1208_02.
5. "ROAD CLOSED" AND "STOP" (31-0557) SIGNS SHALL BE DISPLAYED IN FRONT OF TYPE III BARRICADES.

- SIGN ON SINGLE POST
- SIGN ON DOUBLE POST
- ⊥ PORTABLE SIGN SUPPORT
- BARRICADE WARNING LIGHT - HIGH INTENSITY
- ▬ TYPE III BARRICADE

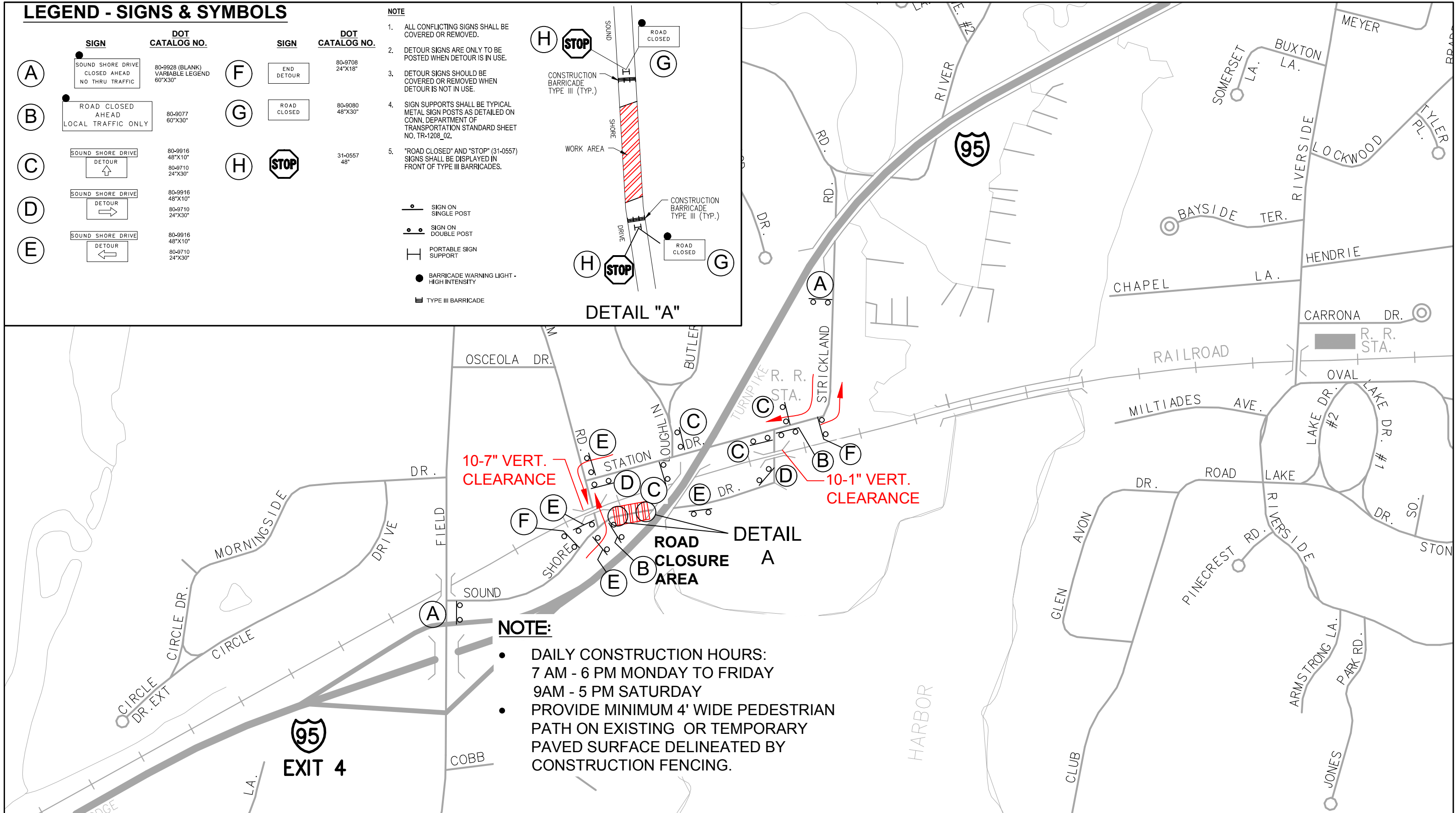
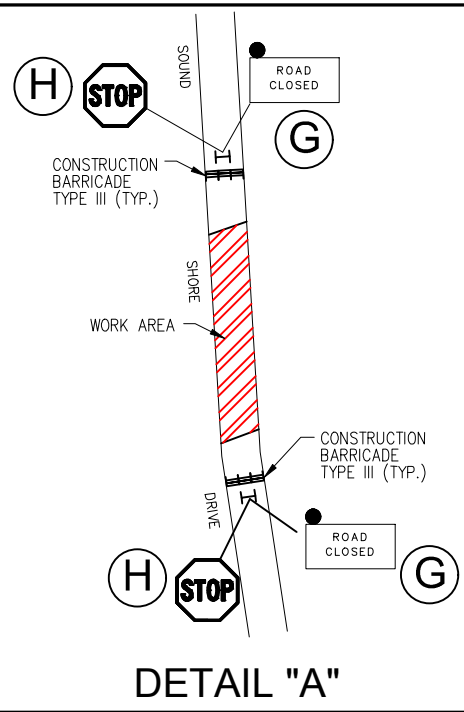

NOTE:

- DAILY CONSTRUCTION HOURS:
7 AM - 6 PM MONDAY TO FRIDAY
9AM - 5 PM SATURDAY
- PROVIDE MINIMUM 4' WIDE PEDESTRIAN PATH ON EXISTING OR TEMPORARY PAVED SURFACE DELINEATED BY CONSTRUCTION FENCING.



Alfred Benesch & Company • www.benesch.com
120 Hebron Avenue • Glastonbury, Connecticut 06033
Phone: (860) 633-8341 • Fax: (860) 633-1068



1" = 500'

DETOUR PLAN 1A SOUND SHORE DRIVE DETOUR

EVERSOURCE 115 KV Underground Transmissions Facility
From CosCob Substation To New Greenwich Substation