

LEGEND - SIGNS & SYMBOLS

SIGN	DOT CATALOG NO.	SIGN	DOT CATALOG NO.
(A) FIELD POINT ROAD CLOSED AHEAD NO THRU TRAFFIC	80-9928 (BLANK) VARIABLE LEGEND 60"x30"	(H) END DETOUR	80-9708 24"x18"
(B) ROAD CLOSED AHEAD LOCAL TRAFFIC ONLY	80-9077 60"x30"	(I) ROAD CLOSED	80-9080 48"x30"
(C) FIELD POINT ROAD DETOUR (up arrow)	80-9916 48"x10" 80-9710 24"x30"	(J) STOP	31-0557 48"
(D) FIELD POINT ROAD DETOUR (right arrow)	80-9916 48"x10" 80-9710 24"x30"	SIGN ON SINGLE POST	
(E) FIELD POINT ROAD DETOUR (left arrow)	80-9916 48"x10" 80-9710 24"x30"	SIGN ON DOUBLE POST	
		PORTABLE SIGN SUPPORT	
		BARRICADE WARNING LIGHT - HIGH INTENSITY	
		TYPE III BARRICADE	

NOTE

1. ALL CONFLICTING SIGNS SHALL BE COVERED OR REMOVED.
2. DETOUR SIGNS ARE ONLY TO BE POSTED WHEN DETOUR IS IN USE.
3. DETOUR SIGNS SHOULD BE COVERED OR REMOVED WHEN DETOUR IS NOT IN USE.
4. SIGN SUPPORTS SHALL BE TYPICAL METAL SIGN POSTS AS DETAILED ON CONN. DEPARTMENT OF TRANSPORTATION STANDARD SHEET NO. TR-1208_02.
5. "ROAD CLOSED" AND "STOP" (31-0557) SIGNS SHALL BE DISPLAYED IN FRONT OF TYPE III BARRICADES.

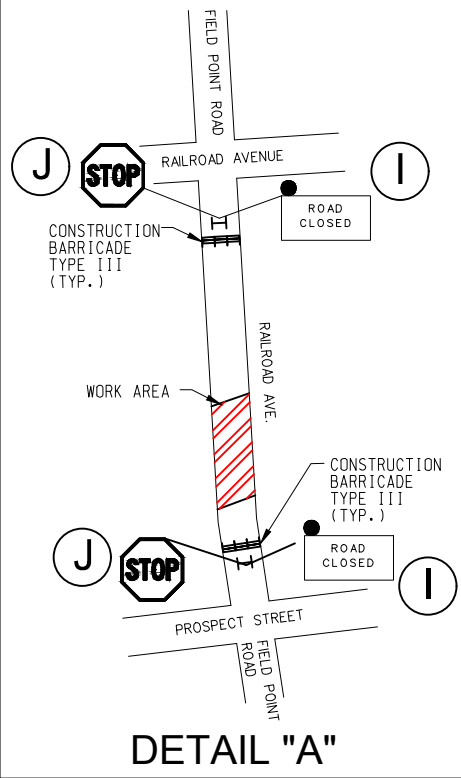

NOTE:

THE CONTRACTOR SHALL HAVE THE OPTION OF WORKING DURING ONLY ONE OF THE FOLLOWING DAILY CONSTRUCTION TIME FRAMES:

9AM - 3PM MONDAY TO FRIDAY AND
9AM - 5PM SATURDAY

OR

9PM - 5AM SUNDAY TO THURSDAY
(NIGHT CONSTRUCTION AS ALLOWED BY LOCAL ORDINANCE OR APPLICABLE PERMITS)

MAINTAIN EXISTING PEDESTRIAN WALKWAYS.

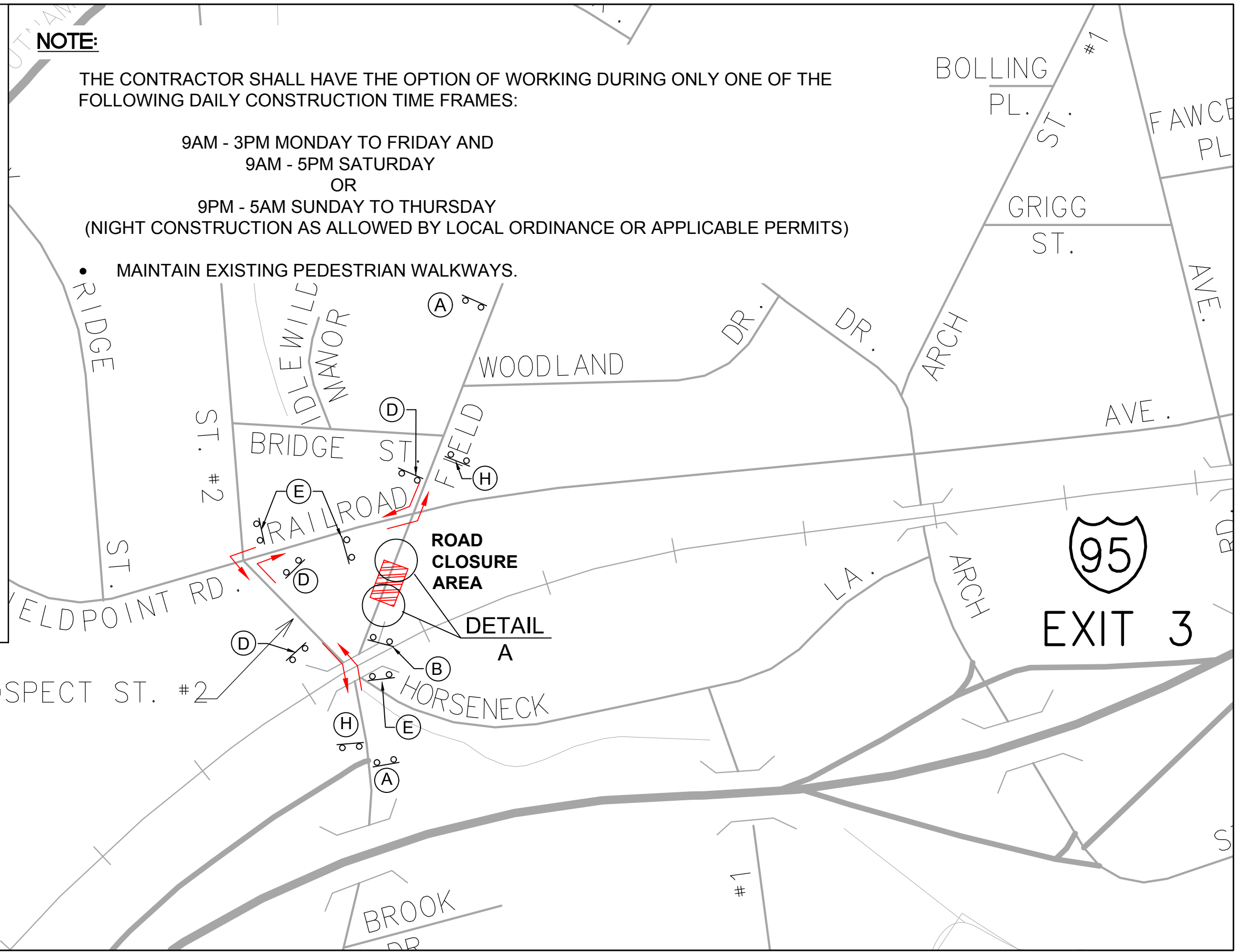

Alfred Benesch & Company • www.benesch.com
120 Hebron Avenue • Glastonbury, Connecticut 06033
Phone: (860) 633-8341 • Fax: (860) 633-1068



1" = 250'

DETOUR PLAN 1
FIELD POINT ROAD DETOUR
EVERSOURCE 115 KV Underground Transmissions Facility
Greenwich Substation